

# Customer Information Sheet

DRAWING No.: M22-5430405R

IF IN DOUBT - ASK

©

NOT TO SCALE

THIRD ANGLE PROJECTION

ALL DIMENSIONS IN mm

**NOTES:**

- THIS PRODUCT IS TAPE AND REELED IN GENERAL ACCORDANCE WITH EIA-481-2 (ELECTRONICS INDUSTRIES ASSOCIATION).
- THIS DRAWING IS FOR TAPE AND REELED VERSION OF M22-5430405, FOR LOOSE OPTION, SEE DRAWING M22-543XX05.

**SPECIFICATION:**

**MATERIAL:**  
 MOULDING = PA9T UL94V-0, BLACK  
 CONTACT = BRASS

**FINISH:**  
 CONTACT = GOLD FLASH OVER NICKEL

**ELECTRICAL:**  
 CURRENT RATING = 2A  
 CONTACT RESISTANCE = 20mΩ MAX  
 INSULATION RESISTANCE = 1000 MΩ MIN  
 DIELECTRIC STRENGTH = 500V AC/DC MINUTE

**ENVIRONMENTAL:**  
 TEMPERATURE RANGE = -40°C TO +105°C

**PACKING:** BOX  
 FOR COMPLETE SPECIFICATION, SEE COMPONENT SPECIFICATION C018XX (LATEST ISSUE)

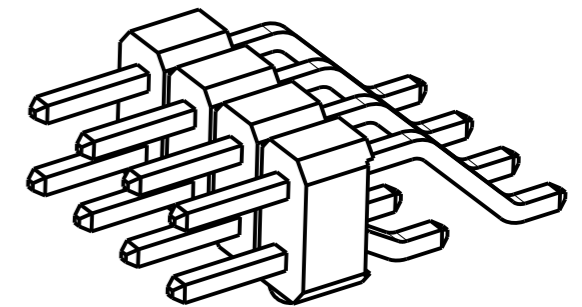
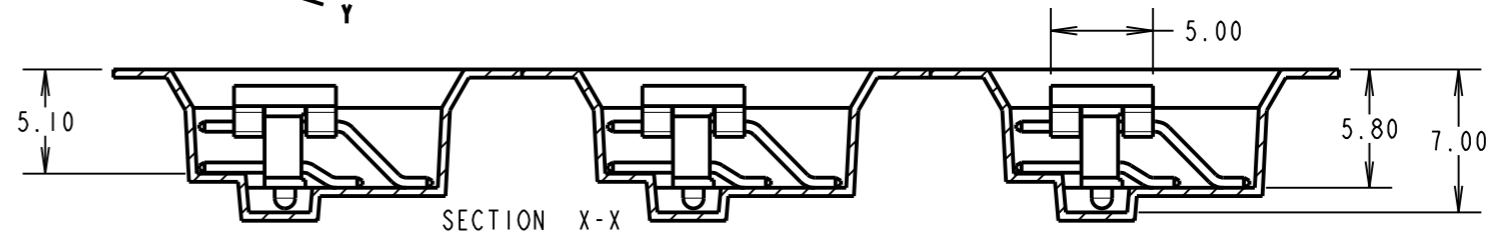
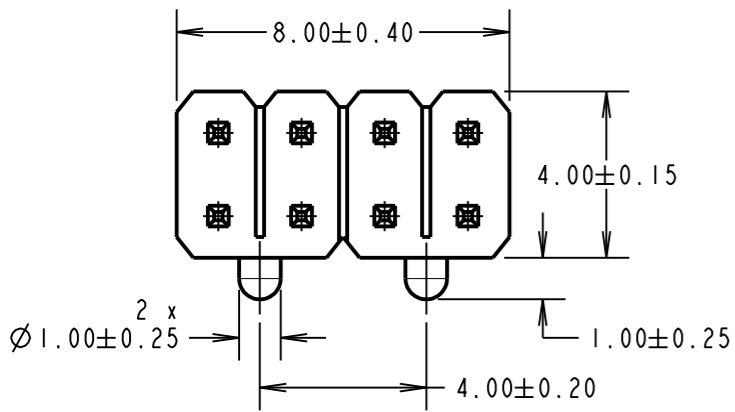
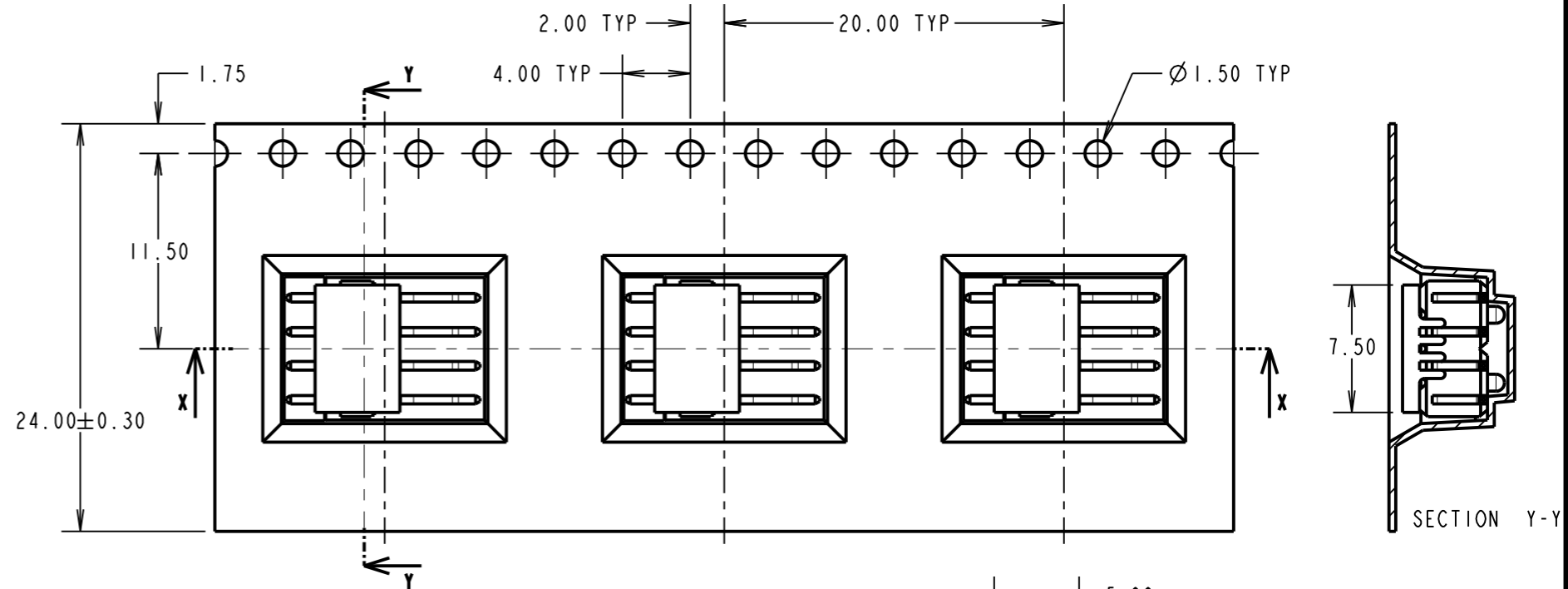

**COMPONENT DETAILS**  
 CAP HIDDEN FOR ILLUSTRATION ONLY

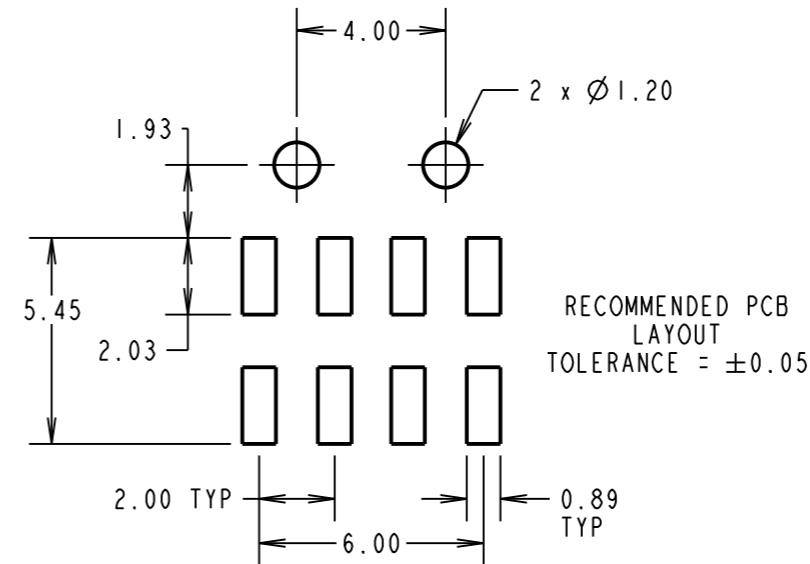
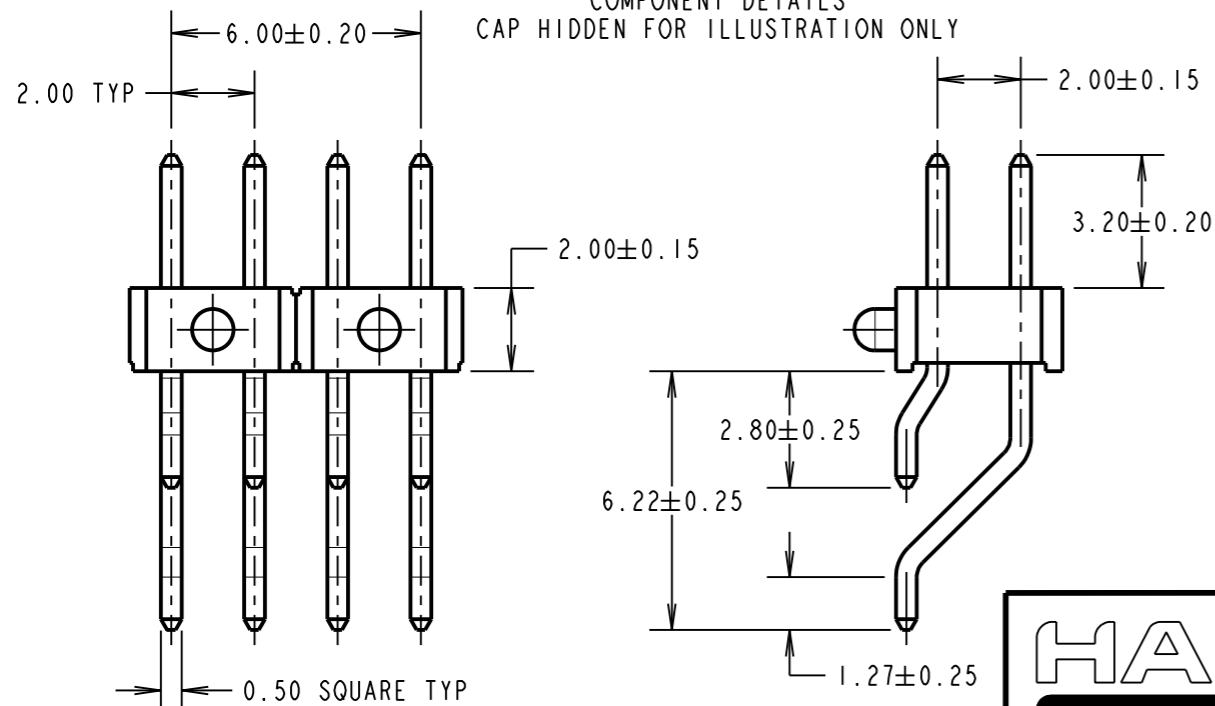

SB	1	05.01.15	12759
NAME	ISS.	DATE	C/NOTE
APPROVED: S.BENNETT			
CHECKED: M.PLESTED			
DRAWN: S.BENNETT			
CUSTOMER REF.:			
ASSEMBLY DRG:			

<p>www.harwin.com                  technical@harwin.com</p>	<p>THIS DRAWING AND ANY INFORMATION OR DESCRIPTIVE MATTER SET OUT HEREON ARE CONFIDENTIAL AND COPYRIGHT PROPERTY OF THE HARWIN GROUP AND MUST NOT BE DISCLOSED, LOANED, COPIED OR USED FOR MANUFACTURING, TENDERING OR FOR ANY OTHER PURPOSE WITHOUT THEIR WRITTEN PERMISSION.</p>	<p><b>TOLERANCES</b>                  X. = ±1mm                  X.X = ±0.50mm                  X.XX = ±0.10mm                  X.XXX = ±0.01mm                  ANGLES = ±5°                  UNLESS STATED</p>	<p><b>MATERIAL:</b>                  SEE ABOVE</p>	<p><b>TITLE:</b>                  2.00mm PITCH DIL HORIZONTAL SMT PIN HEADER ASSEMBLY</p>	<p><b>DRAWING NUMBER:</b>                  M22-5430405R</p>	<p>SHT                  2 OF 2</p>
			<p><b>FINISH:</b> SEE ABOVE</p>			

# Customer Information Sheet

DRAWING No.: M22-5431005R

IF IN DOUBT - ASK

©

NOT TO SCALE

THIRD ANGLE PROJECTION

ALL DIMENSIONS IN mm

**NOTES:**

1. THIS PRODUCT IS TAPE AND REELED IN GENERAL ACCORDANCE WITH EIA-481-2 (ELECTRONICS INDUSTRIES ASSOCIATION).
2. THIS DRAWING IS FOR TAPE AND REELED VERSION OF M22-5431005, FOR LOOSE OPTION, SEE DRAWING M22-543XX05.

**SPECIFICATION:**

**MATERIAL:**  
 MOULDING = PA9T UL94V-0, BLACK  
 CONTACT = BRASS

**FINISH:**  
 CONTACT = GOLD FLASH OVER NICKEL

**ELECTRICAL:**  
 CURRENT RATING = 2A  
 CONTACT RESISTANCE = 20mΩ MAX  
 INSULATION RESISTANCE = 1000 MΩ MIN  
 DIELECTRIC STRENGTH = 500V AC/DC MINUTE

**ENVIRONMENTAL:**  
 TEMPERATURE RANGE = -40°C TO +125°C

**PACKING:** BOX  
 FOR COMPLETE SPECIFICATION, SEE COMPONENT SPECIFICATION C018XX (LATEST ISSUE)

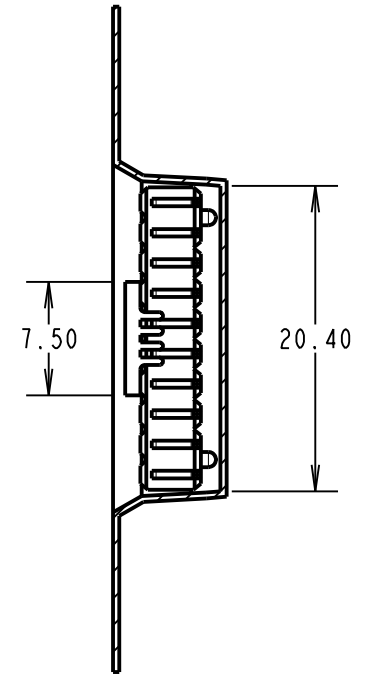
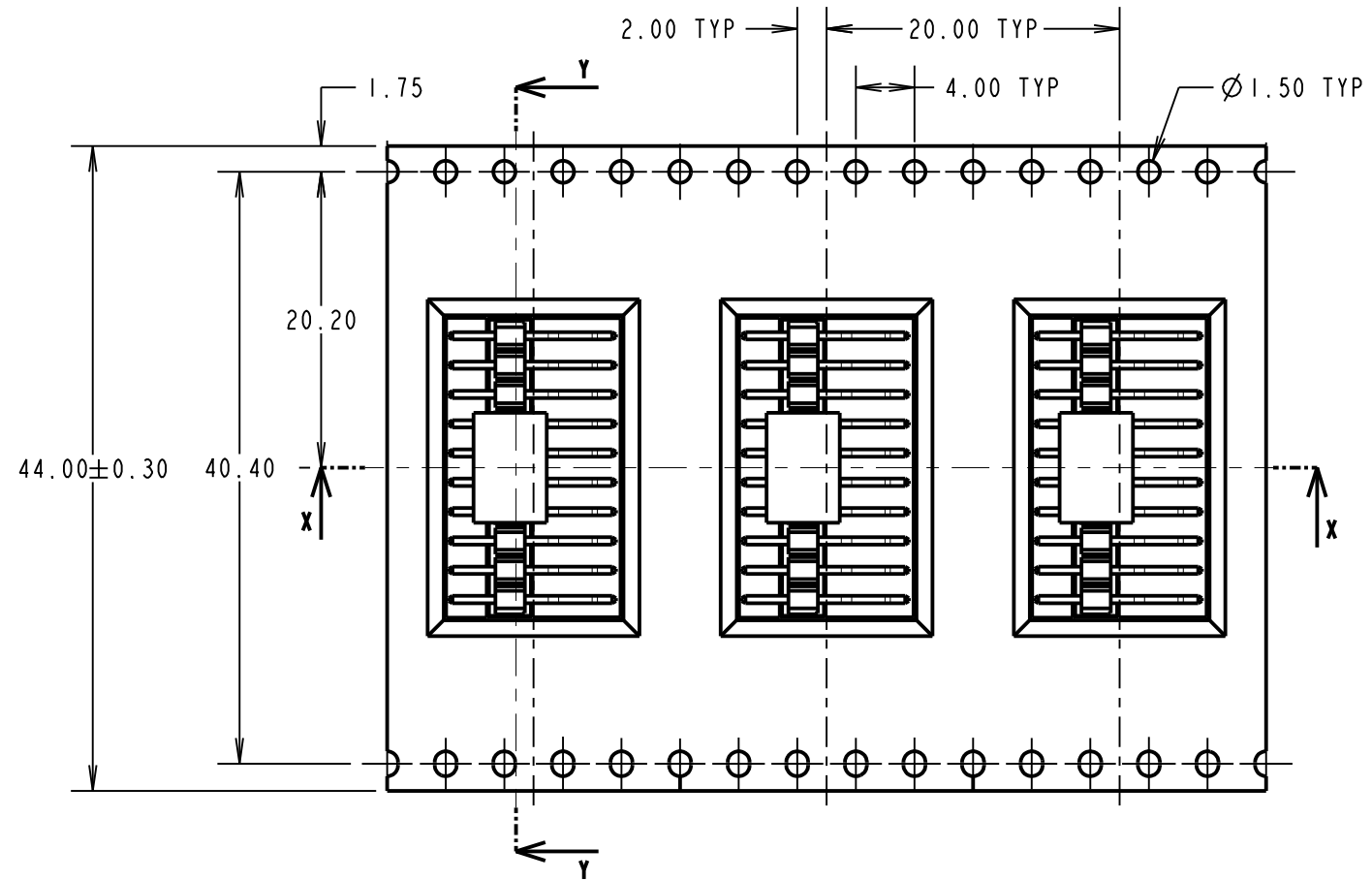
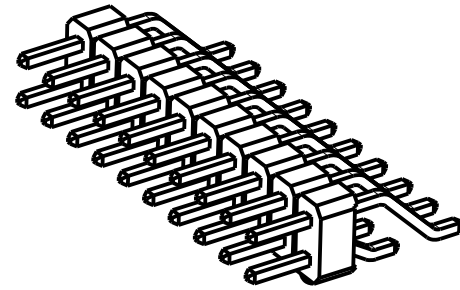

SECTION Y-Y

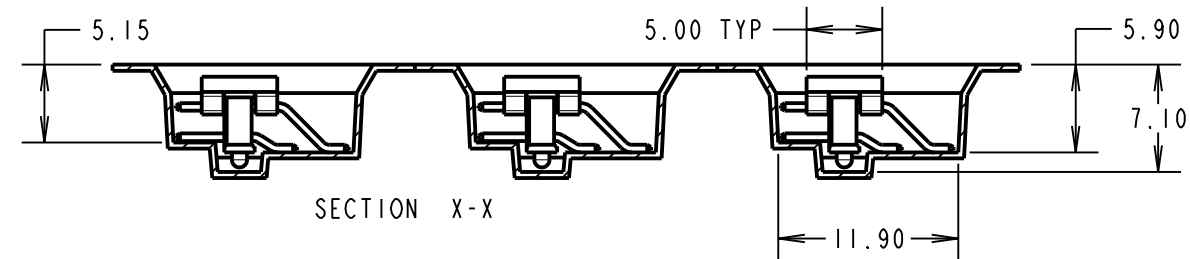

SECTION X-X

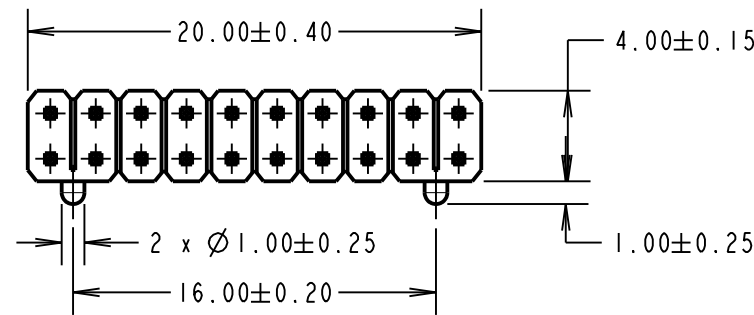

COMPONENT DETAILS  
 CAP HIDDEN FOR ILLUSTRATION ONLY

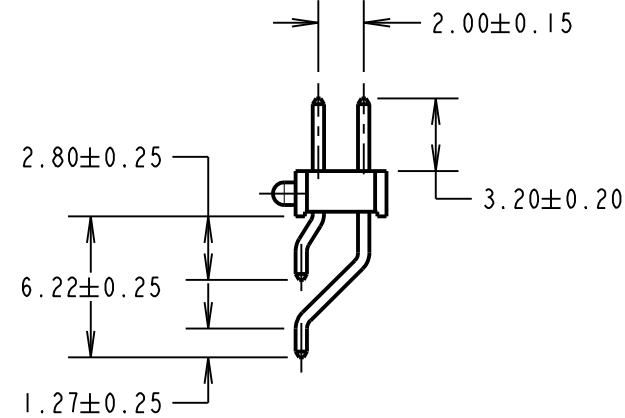
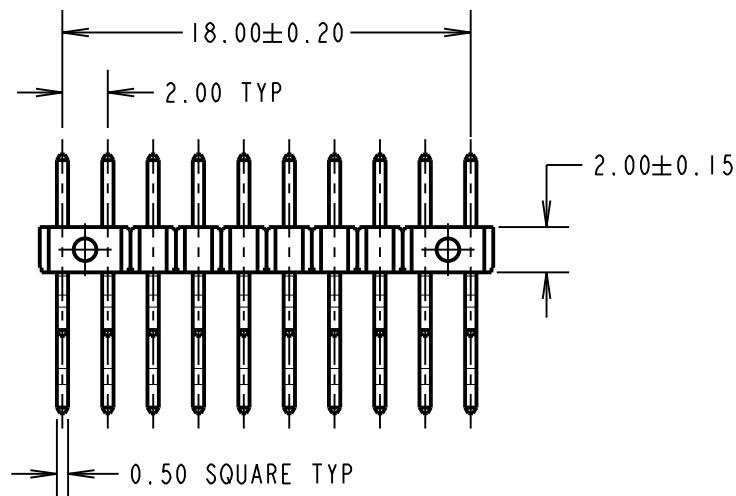

RECOMMENDED PCB LAYOUT  
 TOLERANCE = ±0.05

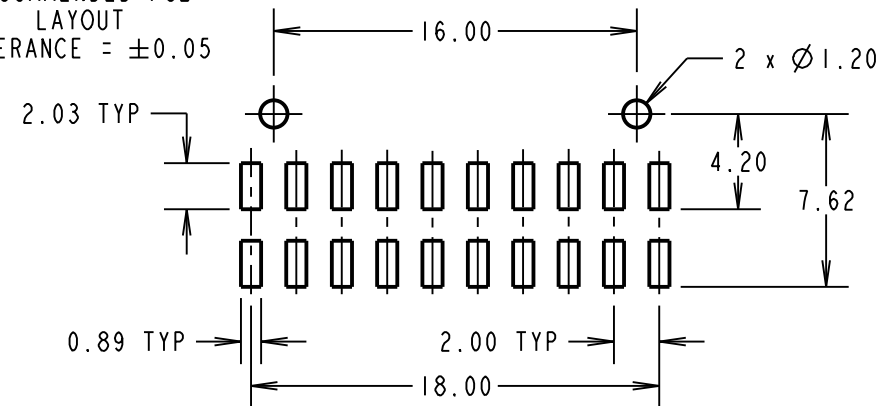

MGP	2	23.11.21	31219
NAME	ISS.	DATE	CN/CO
APPROVED: MGP			
CHECKED: RTP			
DRAWN: M.PLESTED			
CUSTOMER REF.:			
ASSEMBLY DRG:			

**HARWIN**

www.harwin.com  
 technical@harwin.com

THIS DRAWING AND ANY INFORMATION OR DESCRIPTIVE MATTER SET OUT HEREON ARE CONFIDENTIAL AND COPYRIGHT PROPERTY OF THE HARWIN GROUP AND MUST NOT BE DISCLOSED, LOANED, COPIED OR USED FOR MANUFACTURING, TENDERING OR FOR ANY OTHER PURPOSE WITHOUT THEIR WRITTEN PERMISSION.

**TOLERANCES**  
 X. = ±1mm  
 X.X = ±0.50mm  
 X.XX = ±0.20mm  
 X.XXX = ±0.01mm  
 ANGLES = ±5°  
 UNLESS STATED

**MATERIAL:**  
 SEE ABOVE  
**FINISH:** SEE ABOVE  
**S/AREA:** mm<sup>2</sup>

**TITLE:**  
 2.00mm PITCH DIL HORIZONTAL SMT PIN HEADER ASSEMBLY  
**DRAWING NUMBER:**  
 M22-5431005R  
 SHT 2 OF 2